

Paper Blossoms

Mold Paper to Create 3D Realistic Flowers

How To Make a Hydrangea

Punch
Shape
Assemble

Hydrangea Supplies

Punches:

- 6-7 sets of shapes from Mini Petals 64520 in Blue
- 2-4 leaves from Birch Leaf 64502 in Green

Tools:

- Paper Tool Kit and Case 65800
- Craft Molding Mat 65900

Additional:

- Cardstock - Blue, Green
- 1 inch styrofoam ball, painted green, cut in half
- Felt Tip Marker
- Fabri-Tac Glue (Beacon Adhesives)
- Non-stick Craft mat or scrap paper



Punch and Mark Centers

Use only the shapes with round petals. Start by adding a small dot in the center of each flower with a marker.



Cupping the Petals

With shapes on the Craft Molding Mat (McGill #65900), use a 5mm stylus (McGill Paper Tool Kit #65800), placed at a 90° angle to the paper. Press down and roll the stylus around in the center of the shape until it cups up. Do this for all the petals.



Styrofoam

Create a form to attach Mini-Petals. Cut a 1" Styrofoam ball in half. Paint it green using craft paint.



Shaping Leaves

Form 4 Birch Leaf shapes. Place on the Craft Molding Mat (McGill #65900) and press down with the 8mm stylus. (McGill Paper Tool Kit #65800) Move stylus around in small circular motions to soften card stock, making it easier to manipulate. Shape will curl. Use 1mm stylus to add veining details.

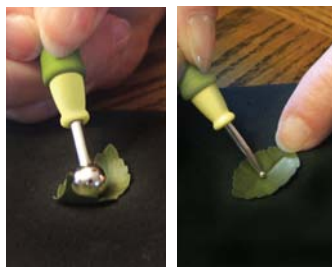

Hydrangea Assembly

(Techniques described at left)

Place a spot of glue on scrap paper or a non-stick craft mat. Dip the base of each flower in glue and attach to the green form starting at the top of the painted ball and moving around the form. Cover the form completely. [Caution: Don't use glue on or over the Craft Molding Mat. It needs to stay clean and dry.]



Dip the end of each leaf in glue and attach to each side of the flower to complete the Hydrangea.



McGill
INCORPORATED®

www.mcgillinc.com